

B. Tingley Soils Map

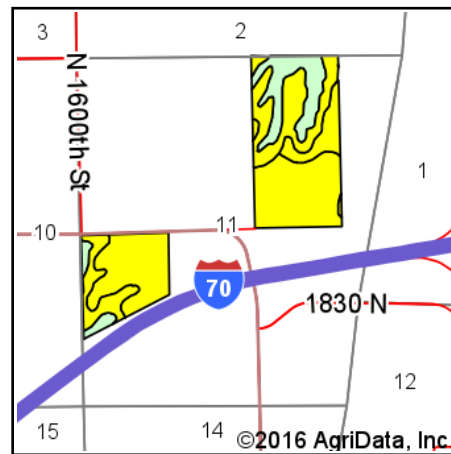

State: **Illinois**
 County: **Clark**
 Location: **11-11N-12W**
 Township: **Marshall**
 Acres: **117.03**
 Date: **10/20/2016**

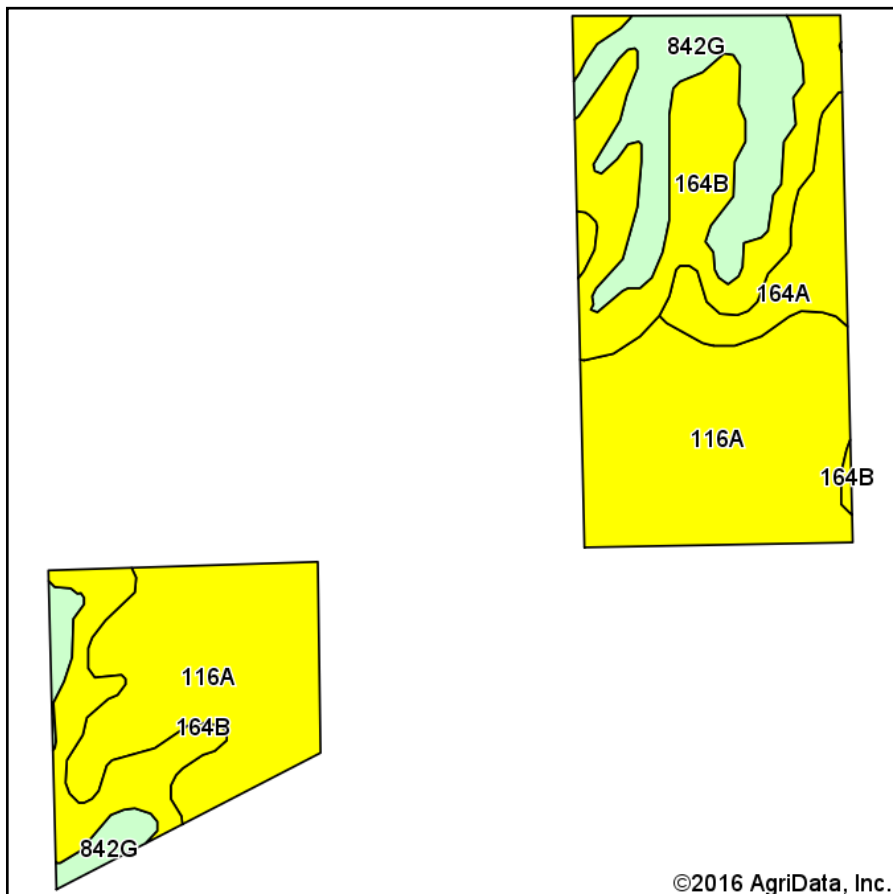

Area Symbol: IL023, Soil Area Version: 10

Code	Soil Description	Acres	Percent of field	Il. State Productivity Index Legend	Subsoil rooting ^a	Corn Bu/A	Soybeans Bu/A	Wheat Bu/A	Oats Bu/A ^b	Sorghum Bu/A ^c	Alfalfa hay, T/A ^d	Grass-legume hay, T/A ^e	Crop productivity index for optimum management
116A	Whitson silt loam, 0 to 2 percent slopes	57.18	48.9%		FAV	158	50	60	75	0	0.00	4.77	116
**164B	Stoy silt loam, 2 to 5 percent slopes	31.22	26.7%		FAV	**144	**47	**57	0	**112	0.00	**4.59	**108
842G	Hickory-Rock outcrop complex, 35 to 60 percent slopes	20.17	17.2%										
164A	Stoy silt loam, 0 to 2 percent slopes	8.46	7.2%		FAV	145	47	58	0	113	0.00	4.64	109
Weighted Average						126.1	40.4	48.7	36.6	38	0.00	3.89	93.4

Area Symbol: IL023, Soil Area Version: 10

Table: Optimum Crop Productivity Ratings for Illinois Soil by K.R. Olson and J.M. Lang, Office of Research, ACES, University of Illinois at Champaign-Urbana. Version: 1/2/2012 Amended Table S2 B811

Crop yields and productivity indices for optimum management (B811) are maintained at the following NRES web site:

<https://www.ideals.illinois.edu/handle/2142/1027/>

** Indexes adjusted for slope and erosion according to Bulletin 811 Table S3

^a UNF = unfavorable; FAV = favorable

^b Soils in the southern region were not rated for oats and are shown with a zero "0".

^c Soils in the northern region or in both regions were not rated for grain sorghum and are shown with a zero "0".

^d Soils in the poorly drained group were not rated for alfalfa and are shown with a zero "0".

^e Soils in the well drained group were not rated for grass-legume and are shown with a zero "0".

Soils data provided by USDA and NRCS. Soils data provided by University of Illinois at Champaign-Urbana.

*c: Using Capabilities Class Dominant Condition Aggregation Method