

# Bush Soils Map

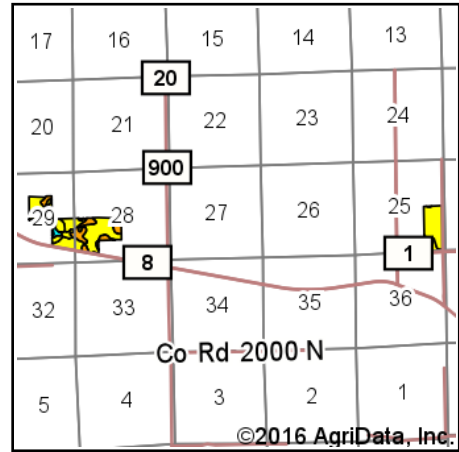

State: **Illinois**  
 County: **Clark**  
 Location: **27-12N-13W**  
 Township: **Dolson**  
 Acres: **256.05**  
 Date: **10/25/2016**

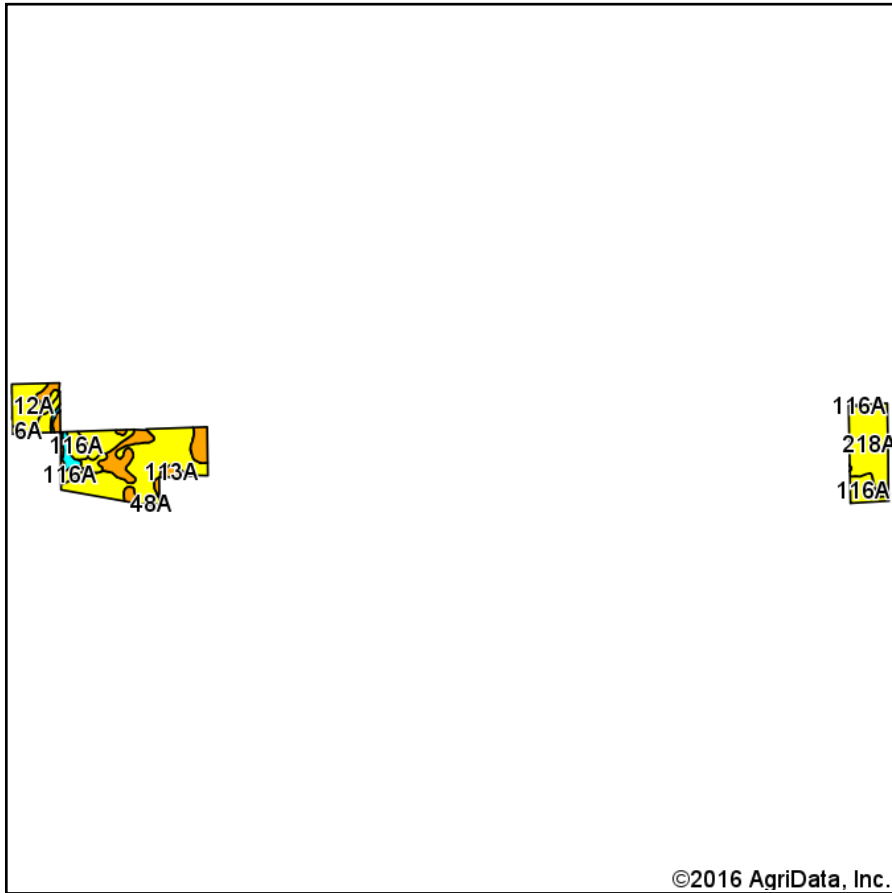

Soils data provided by USDA and NRCS.

©2016 AgriData, Inc.

© AgriData, Inc. 2016

www.AgrIDataInc.com

## Area Symbol: IL023, Soil Area Version: 10

| Code                    | Soil Description  | Acres  | Percent of field | Il. State Productivity Index Legend | Subsoil rooting <sup>a</sup> | Corn Bu/A    | Soybeans Bu/A | Wheat Bu/A  | Oats Bu/A <sup>b</sup> | Sorghum Bu/A <sup>c</sup> | Alfalfa hay, T/A <sup>d</sup> | Grass-legume hay, T/A <sup>e</sup> | Crop productivity index for optimum management |
|-------------------------|---|--------|------------------|-------------------------------------|------------------------------|--------------|---------------|-------------|------------------------|---------------------------|-------------------------------|------------------------------------|--|
| 112A                    | Cowden silt loam, 0 to 2 percent slopes                     | 118.50 | 46.3%            | Yellow                              | FAV                          | 159          | 49            | 63          | 0                      | 119                       | 0.00                          | 4.89                               | 117  |
| 218A                    | Newberry silt loam, 0 to 2 percent slopes                   | 50.58  | 19.8%            | Yellow                              | FAV                          | 155          | 48            | 60          | 0                      | 119                       | 0.00                          | 4.77                               | 114  |
| 48A                     | Ebbert silt loam, 0 to 2 percent slopes                     | 31.47  | 12.3%            | Orange                              | FAV                          | 173          | 55            | 66          | 0                      | 124                       | 0.00                          | 5.14                               | 125  |
| 116A                    | Whitson silt loam, 0 to 2 percent slopes                    | 31.46  | 12.3%            | Yellow                              | FAV                          | 158          | 50            | 60          | 75                     | 0                         | 0.00                          | 4.77                               | 116  |
| 113A                    | Oconee silt loam, 0 to 2 percent slopes                     | 8.84   | 3.5%             | Orange                              | FAV                          | 164          | 50            | 63          | 0                      | 119                       | 0.00                          | 5.27                               | 119  |
| **946D2                 | Hickory-Atlas silt loams, 10 to 18 percent slopes, eroded   | 6.85   | 2.7%             | Cyan                                | UNF                          | **100        | **34          | **40        | **46                   | 0                         | 0.00                          | **3.20                             | **76   |
| **164B                  | Stoy silt loam, 2 to 5 percent slopes                       | 4.76   | 1.9%             | Yellow                              | FAV                          | **144        | **47          | **57        | 0                      | **112                     | 0.00                          | **4.59                             | **108  |
| 3424A                   | Shoals silt loam, 0 to 2 percent slopes, frequently flooded | 3.59   | 1.4%             | Orange                              | FAV                          | 174          | 55            | 69          | 88                     | 0                         | 0.00                          | 5.27                               | 127  |
| <b>Weighted Average</b> |   |        |                  |                                     |                              | <b>158.3</b> | <b>49.3</b>   | <b>61.8</b> | <b>11.7</b>            | <b>100</b>                | <b>0.00</b>                   | <b>4.85</b>                        | <b>116.2</b>                                   |

Area Symbol: IL023, Soil Area Version: 10

**Table: Optimum Crop Productivity Ratings for Illinois Soil by K.R. Olson and J.M. Lang, Office of Research, ACES, University of Illinois at Champaign-Urbana.** Version: 1/2/2012 Amended Table S2 B811

Crop yields and productivity indices for optimum management (B811) are maintained at the following NRES web site:  
<https://www.ideals.illinois.edu/handle/2142/1027/>

\*\* Indexes adjusted for slope and erosion according to Bulletin 811 Table S3

**a** UNF = unfavorable; FAV = favorable

**b** Soils in the southern region were not rated for oats and are shown with a zero "0".

**c** Soils in the northern region or in both regions were not rated for grain sorghum and are shown with a zero "0".

**d** Soils in the poorly drained group were not rated for alfalfa and are shown with a zero "0".

**e** Soils in the well drained group were not rated for grass-legume and are shown with a zero "0".

Soils data provided by USDA and NRCS. Soils data provided by University of Illinois at Champaign-Urbana.

\*c: Using Capabilities Class Dominant Condition Aggregation Method