

Doll FFF II LP Soils Map

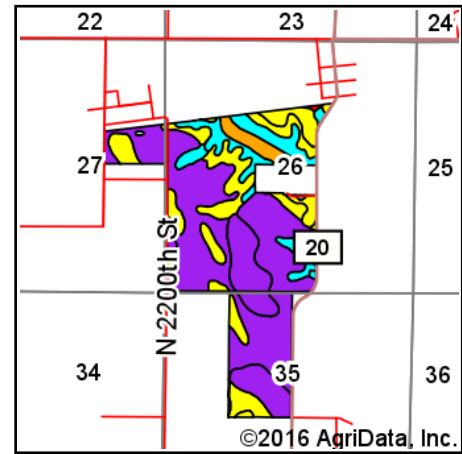

State: **Illinois**
 County: **Clark**
 Location: **26-12N-11W**
 Township: **Wabash**
 Acres: **350.21**
 Date: **10/21/2016**

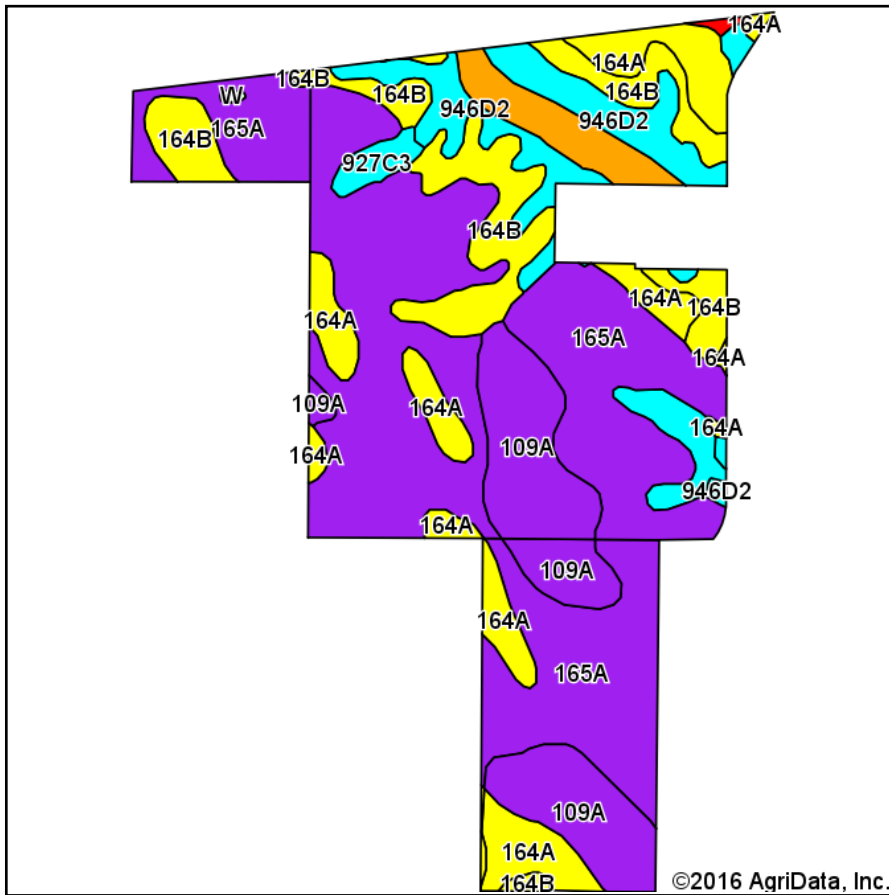

Soils data provided by USDA and NRCS.

Area Symbol: IL023, Soil Area Version: 10

Code	Soil Description	Acres	Percent of field	Il. State Productivity Index Legend	Subsoil rooting	Corn Bu/A	Soybeans Bu/A	Wheat Bu/A	Oats Bu/A	Sorghum Bu/A	Alfalfa hay, T/A	Grass-legume hay, T/A	Crop productivity index for optimum management
165A	Weir silt loam, 0 to 2 percent slopes	168.40	48.1%		FAV	141	46	56	0	112	0.00	4.52	106
109A	Raccoon silt loam, 0 to 2 percent slopes	48.06	13.7%		FAV	144	46	56	0	114	3.89	0.00	106
**164B	Stoy silt loam, 2 to 5 percent slopes	43.03	12.3%		FAV	**144	**47	**57	0	**112	0.00	**4.59	**108
164A	Stoy silt loam, 0 to 2 percent slopes	39.04	11.1%		FAV	145	47	58	0	113	0.00	4.64	109
**946D2	Hickory-Atlas silt loams, 10 to 18 percent slopes, eroded	28.34	8.1%		UNF	**100	**34	**40	**46	0	0.00	**3.20	**76
3424A	Shoals silt loam, 0 to 2 percent slopes, frequently flooded	11.65	3.3%		FAV	174	55	69	88	0	0.00	5.27	127
**927C3	Blair-Atlas silty clay loams, 5 to 10 percent slopes, severely eroded	10.76	3.1%		UNF	**96	**33	**38	0	**84	0.00	**2.99	**73
**927C2	Blair-Atlas silt loams, 5 to 10 percent slopes, eroded	0.62	0.2%		UNF	**117	**40	**47	0	**102	0.00	**3.64	**89
W	Water	0.31	0.1%										
Weighted Average						138.5	45.1	54.9	6.6	98.6	0.53	3.79	103.7

Area Symbol: IL023, Soil Area Version: 10

Table: Optimum Crop Productivity Ratings for Illinois Soil by K.R. Olson and J.M. Lang, Office of Research, ACES, University of Illinois at Champaign-Urbana. Version: 1/2/2012 Amended Table S2 B811

Crop yields and productivity indices for optimum management (B811) are maintained at the following NRES web site:

<https://www.ideals.illinois.edu/handle/2142/1027/>

** Indexes adjusted for slope and erosion according to Bulletin 811 Table S3

a UNF = unfavorable; FAV = favorable

b Soils in the southern region were not rated for oats and are shown with a zero "0".

c Soils in the northern region or in both regions were not rated for grain sorghum and are shown with a zero "0".

d Soils in the poorly drained group were not rated for alfalfa and are shown with a zero "0".

e Soils in the well drained group were not rated for grass-legume and are shown with a zero "0".

Soils data provided by USDA and NRCS. Soils data provided by University of Illinois at Champaign-Urbana.

*c: Using Capabilities Class Dominant Condition Aggregation Method