

Graves Soils Map

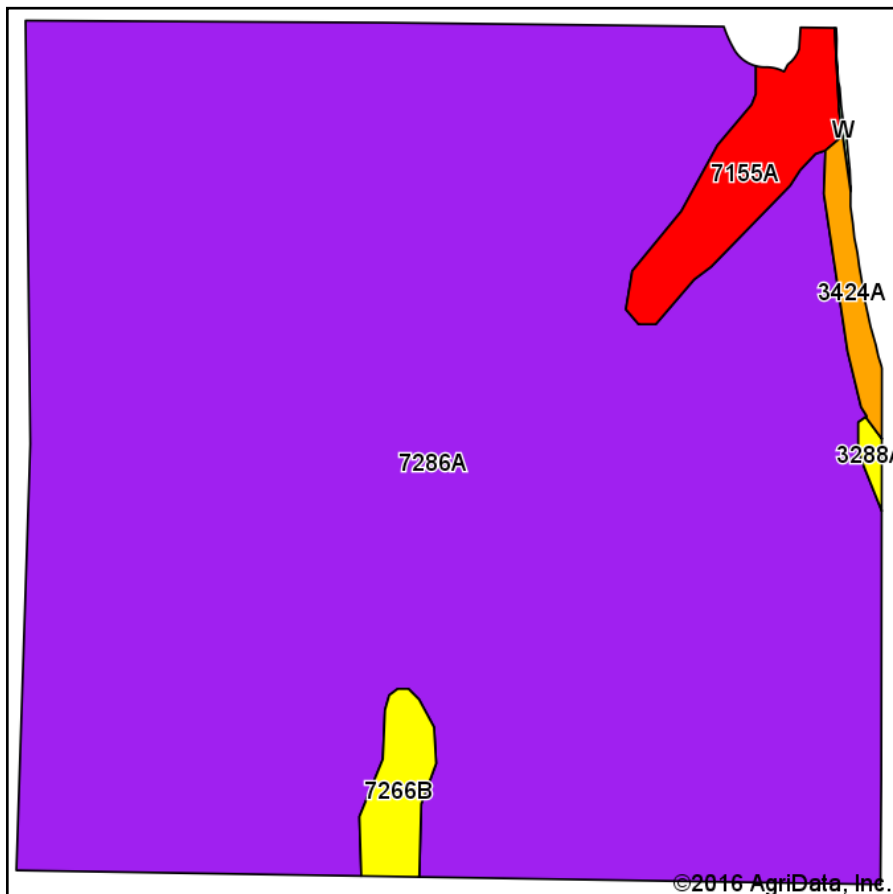

Soils data provided by USDA and NRCS.

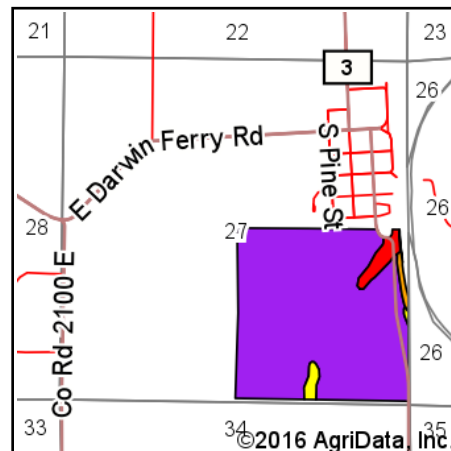

State: **Illinois**
 County: **Clark**
 Location: **27-10N-11W**
 Township: **Darwin**
 Acres: **156.24**
 Date: **10/21/2016**

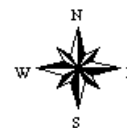

Area Symbol: IL023, Soil Area Version: 10

Code	Soil Description	Acres	Percent of field	Il. State Productivity Index Legend	Subsoil rooting	Corn Bu/A	Soybeans Bu/A	Wheat Bu/A	Oats Bu/A ^b	Sorghum Bu/A	Alfalfa ^d hay, T/A	Grass-legume ^e hay, T/A	Crop productivity index for optimum management
7286 A	Carmi sandy loam, 0 to 2 percent slopes, rarely flooded	147.32	94.3%		FAV	146	45	60	77	0	4.26	0.00	106
7155 A	Stockland gravelly sandy loam, 0 to 2 percent slopes, rarely flooded	4.90	3.1%		UNF	120	42	50	56	0	0.00	4.14	92
7266 B	Disco sandy loam, 2 to 5 percent slopes, rarely flooded	2.14	1.4%		FAV	145	49	58	70	0	3.76	0.00	108
3424 A	Shoals silt loam, 0 to 2 percent slopes, frequently flooded	1.52	1.0%		FAV	174	55	69	88	0	0.00	5.27	127
3288 A	Petrolia silty clay loam, 0 to 2 percent slopes, frequently flooded	0.29	0.2%		FAV	162	49	61	79	0	0.00	4.89	117
W	Water	0.07	0.0%										
Weighted Average						145.4	45	59.7	76.3	*-	4.07	0.19	105.8

Area Symbol: IL023, Soil Area Version: 10

Table: Optimum Crop Productivity Ratings for Illinois Soil by K.R. Olson and J.M. Lang, Office of Research, ACES, University of Illinois at Champaign-Urbana. Version: 1/2/2012 Amended Table S2 B811

Crop yields and productivity indices for optimum management (B811) are maintained at the following NRES web site:

<https://www.ideals.illinois.edu/handle/2142/1027/>

** Indexes adjusted for slope and erosion according to Bulletin 811 Table S3

a UNF = unfavorable; FAV = favorable

b Soils in the southern region were not rated for oats and are shown with a zero "0".

c Soils in the northern region or in both regions were not rated for grain sorghum and are shown with a zero "0".

d Soils in the poorly drained group were not rated for alfalfa and are shown with a zero "0".

e Soils in the well drained group were not rated for grass-legume and are shown with a zero "0".

Soils data provided by USDA and NRCS. Soils data provided by University of Illinois at Champaign-Urbana.

*c: Using Capabilities Class Dominant Condition Aggregation Method