

Tristan Cleer Soils Map

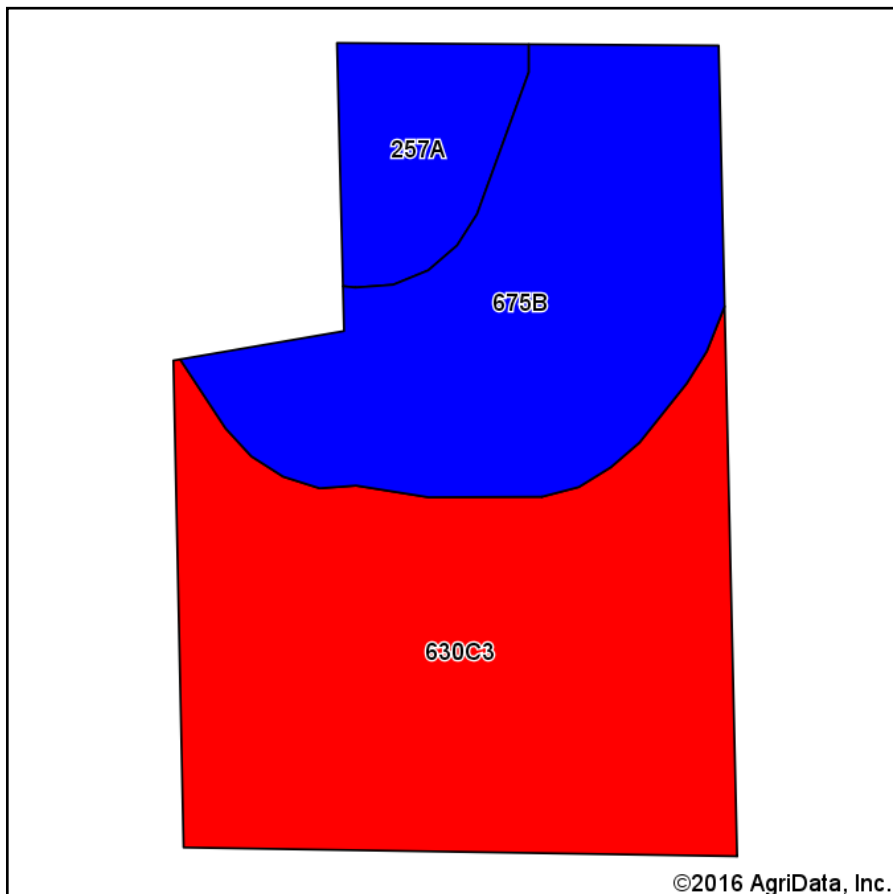

Soils data provided by USDA and NRCS.

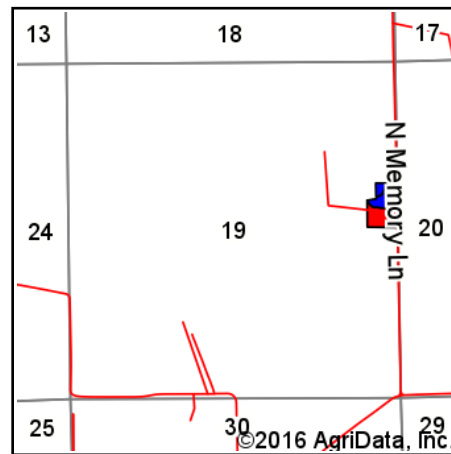

State: **Illinois**
 County: **Fulton**
 Location: **19-4N-3E**
 Township: **Isabel**
 Acres: **6.83**
 Date: **10/4/2016**

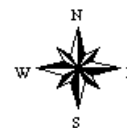

Area Symbol: IL057, Soil Area Version: 10

Code	Soil Description	Acres	Percent of field	Il. State Productivity Index Legend	Subsoil rooting	Corn Bu/A	Soybeans Bu/A	Wheat Bu/A	Oats Bu/A	Sorghum Bu/A	Alfalfa hay, T/A	Grass-legume hay, T/A	Crop productivity index for optimum management
**630C3	Navlys silty clay loam, 5 to 10 percent slopes, severely eroded	3.76	55.1%		FAV	**120	**39	**47	**54	0	0.00	**3.99	**89
**675B	Greenbush silt loam, 2 to 5 percent slopes	2.44	35.7%		FAV	**182	**57	**69	**96	0	0.00	**5.34	**133
257A	Clarksdale silt loam, 0 to 2 percent slopes	0.63	9.2%		FAV	174	56	69	89	0	0.00	5.27	128
Weighted Average						147.1	47	56.9	72.2	*-	0.00	4.59	108.3

Area Symbol: IL057, Soil Area Version: 10

Table: Optimum Crop Productivity Ratings for Illinois Soil by K.R. Olson and J.M. Lang, Office of Research, ACES, University of Illinois at Champaign-Urbana. Version: 1/2/2012 Amended Table S2 B811

Crop yields and productivity indices for optimum management (B811) are maintained at the following NRES web site:

<https://www.ideals.illinois.edu/handle/2142/1027/>

** Indexes adjusted for slope and erosion according to Bulletin 811 Table S3

a UNF = unfavorable; FAV = favorable

b Soils in the southern region were not rated for oats and are shown with a zero "0".

c Soils in the northern region or in both regions were not rated for grain sorghum and are shown with a zero "0".

d Soils in the poorly drained group were not rated for alfalfa and are shown with a zero "0".

e Soils in the well drained group were not rated for grass-legume and are shown with a zero "0".

Soils data provided by USDA and NRCS. Soils data provided by University of Illinois at Champaign-Urbana.

*c: Using Capabilities Class Dominant Condition Aggregation Method