

Soil Map

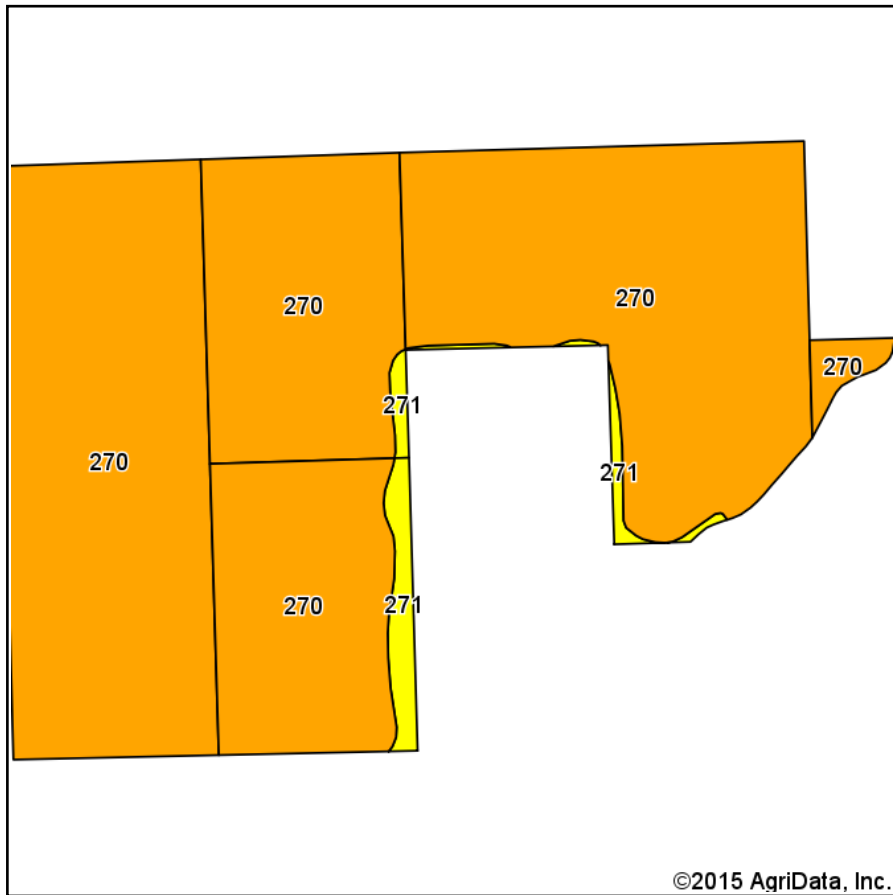

Soils data provided by USDA and NRCS.

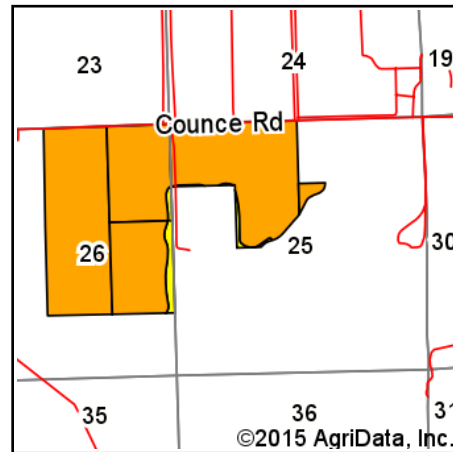

State: **Mississippi**
 County: **Tunica**
 Location: **25-3S-10W**
 Township: **District 1**
 Acres: **359.13**
 Date: **5/28/2015**



Maps Provided By:

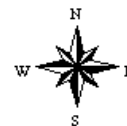

Area Symbol: MS143, Soil Area Version: 7												
Code	Soil Description	Acres	Percent of field	Non-Irr Class Legend	Non-Irr Class *c	Common bermudagrass	Cotton lint	Improved bermudagrass	Rice Irrigated	Soybeans	Tall fescue	Wheat
270	Sharkey clay, 0 to 1 percent slopes, rarely flooded, south	348.10	96.9%		IIIw	6.5	650	10	130	40	9	45
271	Sharkey clay, 0 to 2 percent slopes, frequently flooded	11.03	3.1%		IVw	4.5				30		45
Weighted Average						6.4	630	9.7	126	39.7	8.7	45

Area Symbol: MS143, Soil Area Version: 7

*c: Using Capabilities Class Dominant Condition Aggregation Method

Soils data provided by USDA and NRCS.