

Twiford Soils Map

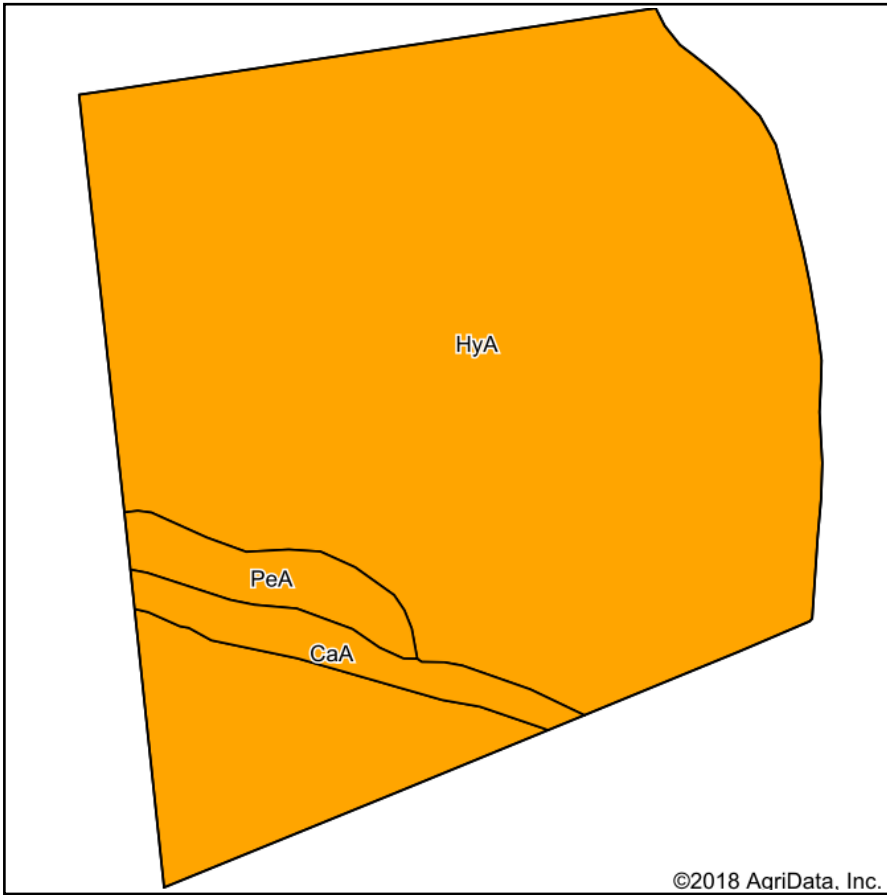

Soils data provided by USDA and NRCS.

©2018 AgriData, Inc.

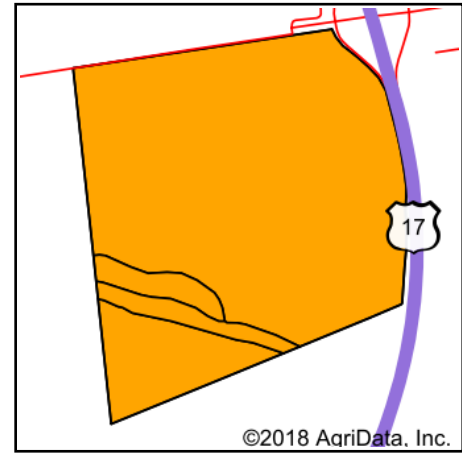

©2018 AgriData, Inc.

State: **North Carolina**
 County: **Pasquotank**
 Location: **36° 17' 2.58, -76° 18' 29.89**
 Township: **Mount Hermon**
 Acres: **486.79**
 Date: **2/20/2018**



Maps Provided By:



© AgriData, Inc. 2018

www.AgriDataInc.com



Area Symbol: NC139, Soil Area Version: 17

Code	Soil Description	Acres	Percent of field	Non-Irr Class Legend	Non-Irr Class *c	Soybeans	Oats	Grain sorghum	Wheat	Corn	Cotton lint	Cabbage	Irish potatoes	Cucumbers	Common bermudagrass	Rye	Imp
HyA	Hyde mucky silt loam, 0 to 2 percent slopes	452.77	93.0%		IIIw	44	93	63	55	134	712	316	278				
CaA	Cape Lookout silt loam, 0 to 2 percent slopes	17.35	3.6%		IIIw	37	84	54	49	111	616						
PeA	Perquimans silt loam, 0 to 2 percent slopes	16.67	3.4%		IIIw	40	86	55	51	117	755	295		10		3	51
Weighted Average						43.6	92.4	62.4	54.6	132.6	710.1	304	258.6	0.3	0.1	1.7	

*c: Using Capabilities Class Dominant Condition Aggregation Method

Soils data provided by USDA and NRCS.