

Soil Map

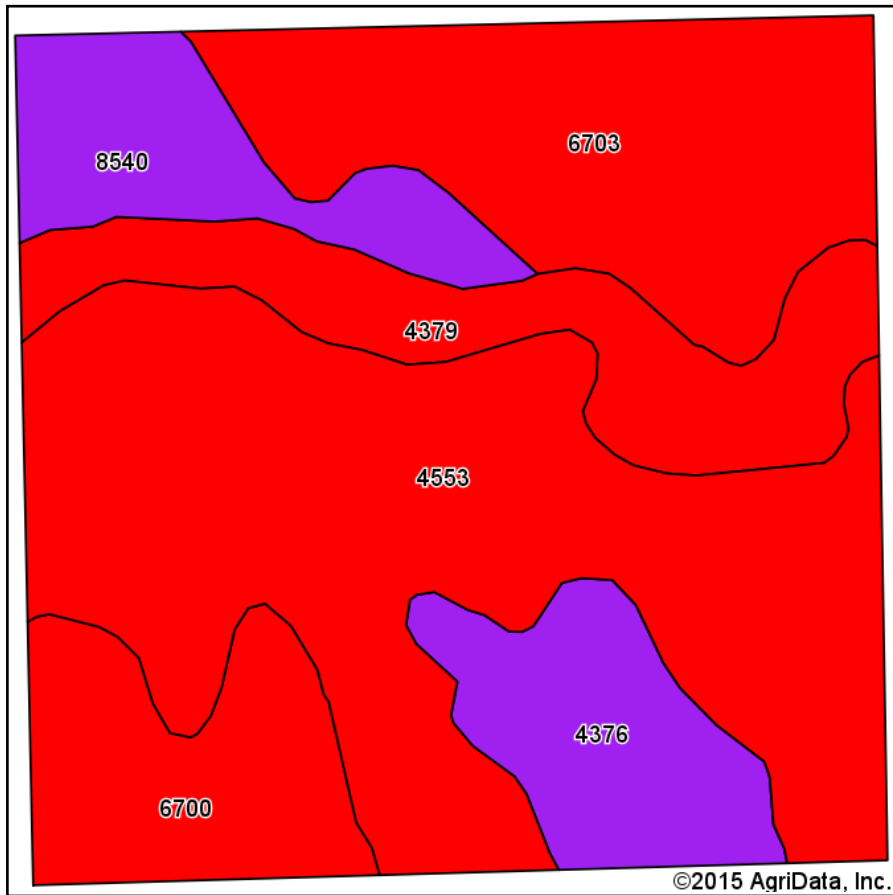

Soils data provided by USDA and NRCS.

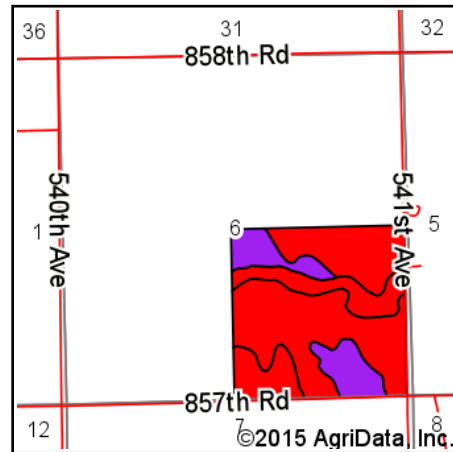

State: **Nebraska**
 County: **Pierce**
 Location: **6-26N-3W**
 Township: **Clover Valley**
 Acres: **156.53**
 Date: **5/11/2015**



Maps Provided By:

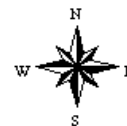

Area Symbol: NE139, Soil Area Version: 13

| Code | Soil Description | Acres | Percent of field | SRPG Legend | Non-Irr Class | Irr Class | SRPG | Alfalfa hay | Corn | Corn Irrigated | Oats | Pasture | Ry e | Soybeans |
|-------------------------|--|-------|------------------|-------------|---------------|-----------|-------------|-------------|-------------|----------------|-------------|------------|------------|-------------|
| 4553 | Elsmere loamy fine sand, 0 to 3 percent slopes | 64.05 | 40.9% | | IVw | IIIw | 29 | 4 | 43 | 95 | 24 | 4 | 19 | 24 |
| 6703 | Thurman loamy fine sand, 2 to 6 percent slopes | 31.52 | 20.1% | | IVe | IVe | 32 | | | | | | | |
| 4379 | Loup soils, rarely flooded | 18.87 | 12.1% | | Vw | | 30 | | | | | | | |
| 6700 | Thurman loamy fine sand, 0 to 2 percent slopes | 15.39 | 9.8% | | IIIe | IIIe | 34 | | | | | | | |
| 4376 | Loup fine sandy loam, rarely flooded | 13.87 | 8.9% | | Vw | | 56 | | 30 | | | | 3 | 10 |
| 8540 | Ovina fine sandy loam, rarely flooded | 12.83 | 8.2% | | IIw | IIw | 54 | 5 | 64 | 127 | 44 | | 5 | 29 |
| Weighted Average | | | | | | | 34.7 | 2 | 25.5 | 49.3 | 13.4 | 2.3 | 8.7 | 13.1 |

Area Symbol: NE139, Soil Area Version: 13

Soils data provided by USDA and NRCS.