

Quinn FFF LP Soils Map

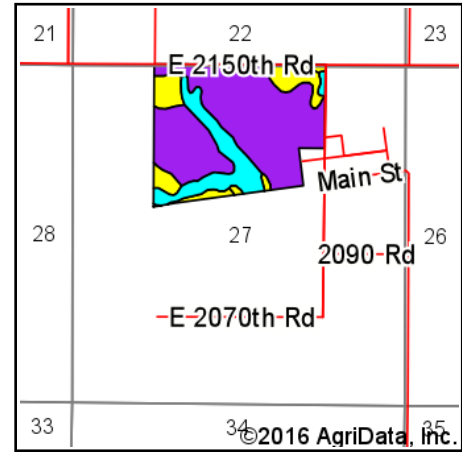

State: **Illinois**
 County: **Clark**
 Location: **27-12N-11W**
 Township: **Wabash**
 Acres: **119.77**
 Date: **10/25/2016**

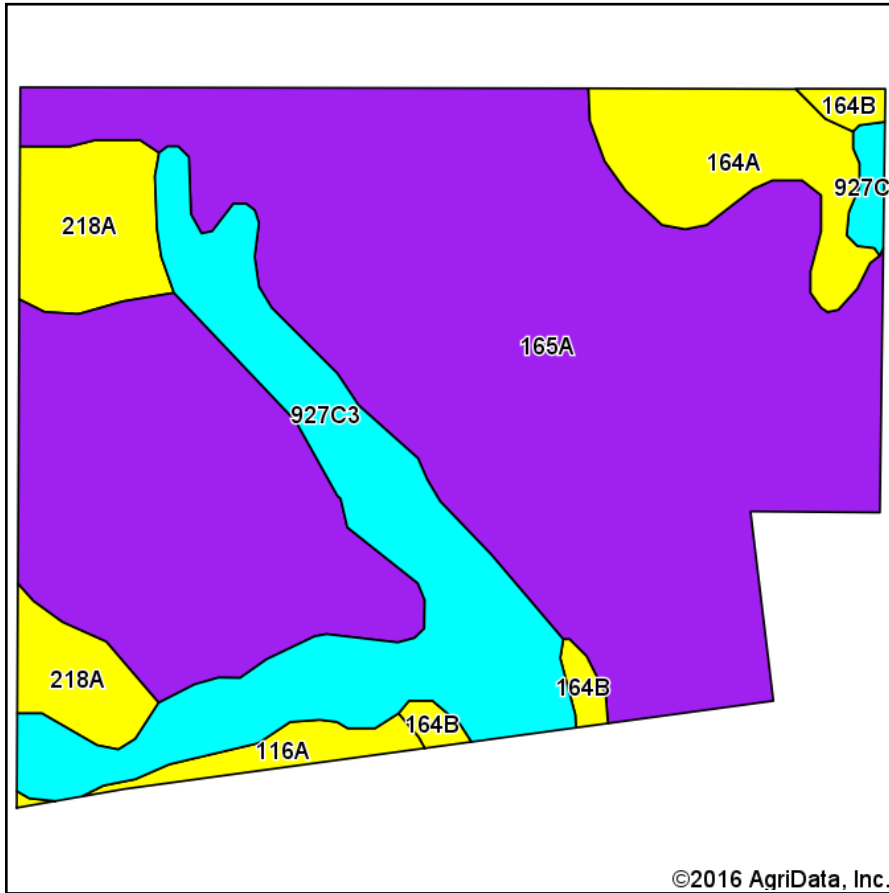

Soils data provided by USDA and NRCS.

©2016 AgriData, Inc.

Area Symbol: IL023, Soil Area Version: 10

Code	Soil Description	Acres	Percent of field	Il. State Productivity Index Legend	Subsoil rooting	Com a Bu/A	Soybeans Bu/A	Whea t Bu/A	Oats Bu/A b	Sorghum c Bu/A	Alfalfa d hay, T/A	Grass-le gume e hay, T/A	Crop productivity index for optimum management
165A	Weir silt loam, 0 to 2 percent slopes	81.98	68.4%		FAV	141	46	56	0	112	0.00	4.52	106
**927C3	Blair-Atlas silty clay loams, 5 to 10 percent slopes, severely eroded	19.49	16.3%		UNF	**96	**33	**38	0	**84	0.00	**2.99	**73
218A	Newberry silt loam, 0 to 2 percent slopes	7.89	6.6%		FAV	155	48	60	0	119	0.00	4.77	114
164A	Stoy silt loam, 0 to 2 percent slopes	6.99	5.8%		FAV	145	47	58	0	113	0.00	4.64	109
116A	Whitson silt loam, 0 to 2 percent slopes	1.85	1.5%		FAV	158	50	60	75	0	0.00	4.77	116
**164B	Stoy silt loam, 2 to 5 percent slopes	1.57	1.3%		FAV	**144	**47	**57	0	**112	0.00	**4.59	**108
Weighted Average						135.1	44.1	53.5	1.2	106.2	0.00	4.30	101.5

Area Symbol: IL023, Soil Area Version: 10

Table: Optimum Crop Productivity Ratings for Illinois Soil by K.R. Olson and J.M. Lang, Office of Research, ACES, University of Illinois at Champaign-Urbana. Version: 1/2/2012 Amended Table S2 B811

Crop yields and productivity indices for optimum management (B811) are maintained at the following NRES web site:

<https://www.ideals.illinois.edu/handle/2142/1027/>

** Indexes adjusted for slope and erosion according to Bulletin 811 Table S3

a UNF = unfavorable; FAV = favorable

b Soils in the southern region were not rated for oats and are shown with a zero "0".

c Soils in the northern region or in both regions were not rated for grain sorghum and are shown with a zero "0".

d Soils in the poorly drained group were not rated for alfalfa and are shown with a zero "0".

e Soils in the well drained group were not rated for grass-legume and are shown with a zero "0".

Soils data provided by USDA and NRCS. Soils data provided by University of Illinois at Champaign-Urbana.

*c: Using Capabilities Class Dominant Condition Aggregation Method