

Shaeff Soils Map

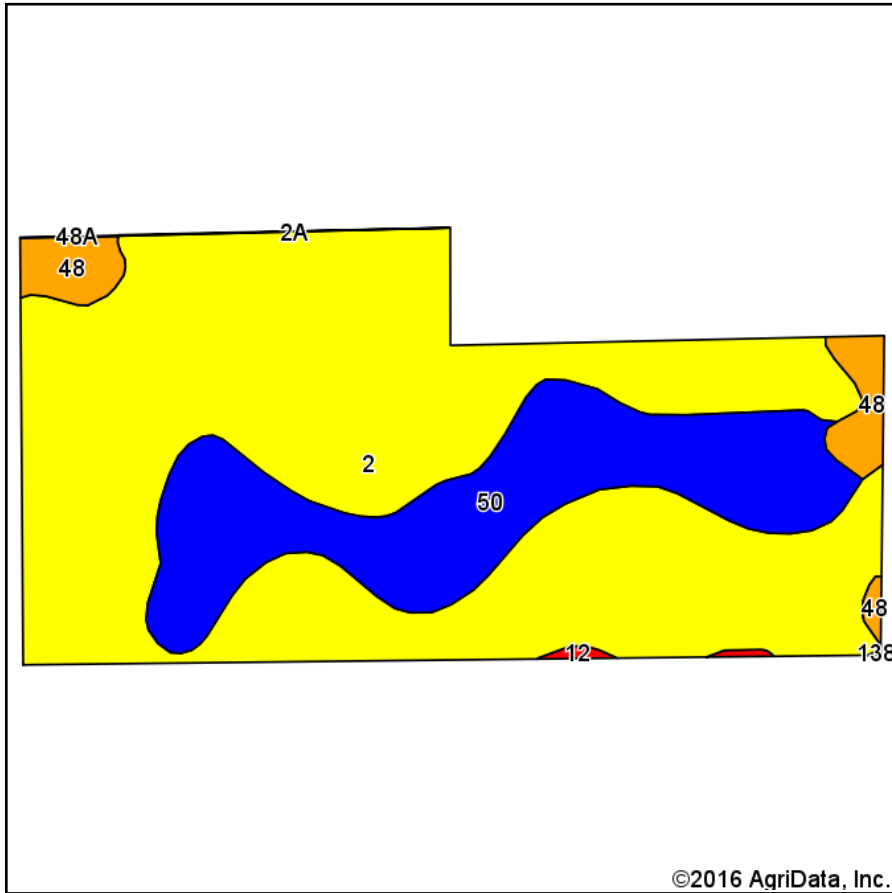

Soils data provided by USDA and NRCS.

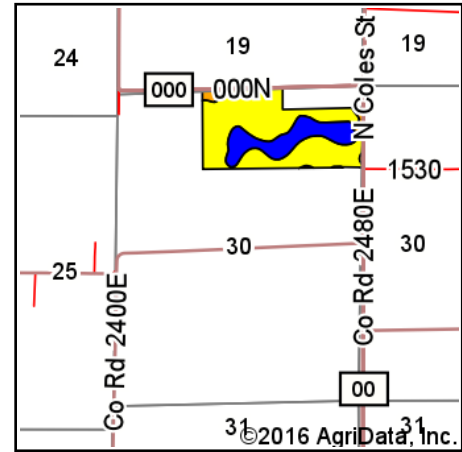

State: **Illinois**
 County: **Cumberland**
 Location: **30-11N-11E**
 Township: **Union**
 Acres: **71.18**
 Date: **10/25/2016**



Maps Provided By:



© AgriData, Inc. 2016

www.AgriDataInc.com



Area Symbol: IL029, Soil Area Version: 15

Area Symbol: IL035, Soil Area Version: 10

Code	Soil Description	Acres	Percent of field	Il. State Productivity Index Legend	Subsoil rooting ^a	Corn Bu/A	Soybeans Bu/A	Wheat Bu/A	Oats Bu/A ^b	Sorghum Bu/A	Alfalfa hay, T/A ^c	Grass-legume hay, T/A ^d	Crop productivity index for optimum management
2	Cisne silt loam, 0 to 2 percent slopes	51.38	72.2%	Yellow	FAV	149	46	59	0	113	0.00	4.64	109
50	Virden silt loam, 0 to 2 percent slopes	16.65	23.4%	Blue	FAV	182	59	71	93	0	0.00	5.27	135
48	Ebbert silt loam	2.87	4.0%	Orange	FAV	173	55	66	0	124	0.00	5.14	125
12	Wynoose silt loam, 0 to 2 percent slopes	0.22	0.3%	Red	FAV	128	42	51	0	108	0.00	4.26	97
2A	Cisne silt loam, 0 to 2 percent slopes	0.06	0.1%	Yellow	FAV	149	46	59	0	113	0.00	4.64	109
Weighted Average						157.6	49.4	62.1	21.8	87	0.00	4.81	115.7

Area Symbol: IL029, Soil Area Version: 15

Area Symbol: IL035, Soil Area Version: 10

Table: Optimum Crop Productivity Ratings for Illinois Soil by K.R. Olson and J.M. Lang, Office of Research, ACES, University of Illinois at Champaign-Urbana. Version: 1/2/2012 Amended Table S2 B811

Crop yields and productivity indices for optimum management (B811) are maintained at the following NRES web site:

<https://www.ideals.illinois.edu/handle/2142/1027/>

** Indexes adjusted for slope and erosion according to Bulletin 811 Table S3

a UNF = unfavorable; FAV = favorable

b Soils in the southern region were not rated for oats and are shown with a zero "0".

c Soils in the northern region or in both regions were not rated for grain sorghum and are shown with a zero "0".

d Soils in the poorly drained group were not rated for alfalfa and are shown with a zero "0".

e Soils in the well drained group were not rated for grass-legume and are shown with a zero "0".

Soils data provided by USDA and NRCS. Soils data provided by University of Illinois at Champaign-Urbana.

*c: Using Capabilities Class Dominant Condition Aggregation Method