

Borden Soils Map

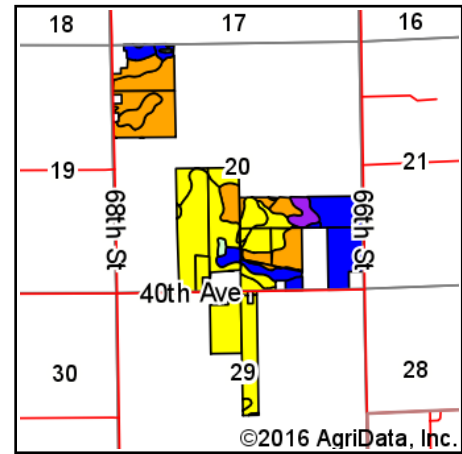

State: **Michigan**
 County: **Van Buren**
 Location: **20-2S-16W**
 Township: **Bangor**
 Acres: **261.97**
 Date: **2/25/2016**

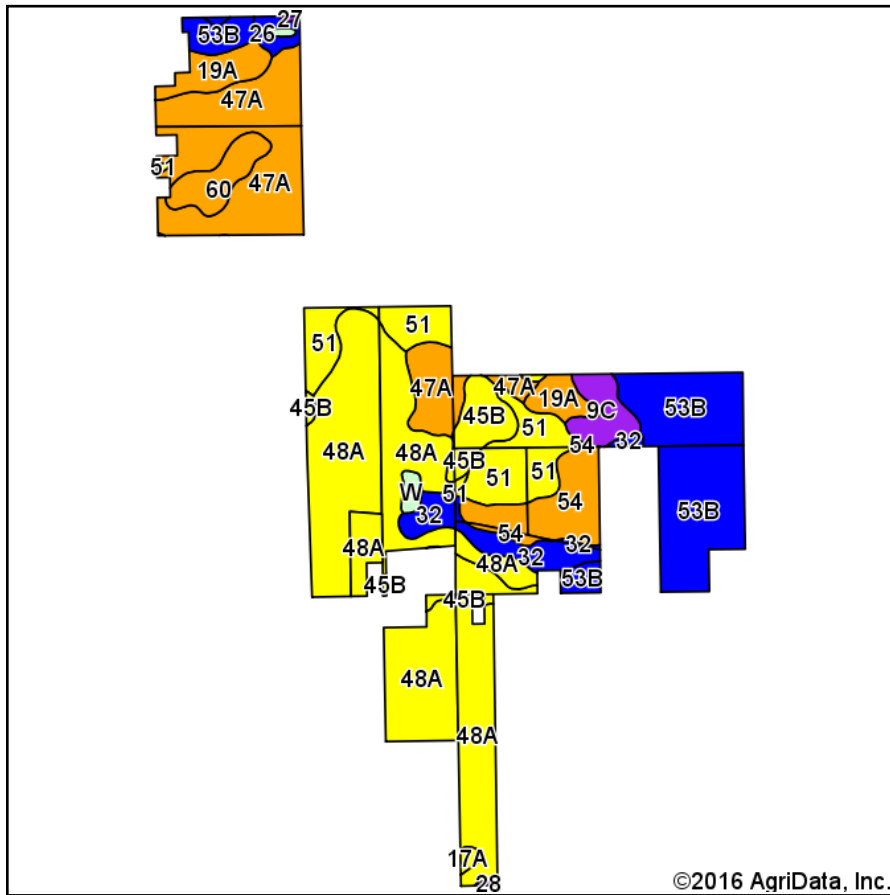

Maps Provided By:



© AgriData, Inc. 2016

www.AgriDataInc.com



Soils data provided by USDA and NRCS.

©2016 AgriData, Inc.

Area Symbol: MI159, Soil Area Version: 11

Cod e	Soil Description	Acres	Percent of field	Non-Irr Class Legend	Non-Irr Class *c	Alfalfa hay	Alfalfa hay Irrigated	Bromegrass alfalfa hay	Canarygrass hay	Corn	Corn Irrigated	Corn silage	Corn silage Irrigated	Grass legume hay	Oat s	Orchardgrass alfalfa hay	Orchardgrass red clover h
48A	Pipestone-Kingsville complex, 0 to 3 percent slopes	88.02	33.6%		IVw	3.5	5.5			65	130	12	22		60		
47A	Selfridge loamy sand, 0 to 3 percent slopes	43.09	16.4%		IIIw	4.2		3		110		18			70		
53B	Capac loam, 0 to 4 percent slopes	42.09	16.1%		Ile												
51	Kingsville loamy sand	24.20	9.2%		IVw					75		12			70		
54	Palms muck	13.63	5.2%		IIIw				3	118		18			72		
45B	Covert sand, 0 to 4 percent slopes	12.02	4.6%		IVs	3.5		2.5		80		13			60		
19A	Ottokee loamy fine sand, 0 to 3 percent slopes	10.40	4.0%		III s					98						3.5	
32	Colwood silt loam	10.22	3.9%		IIw	5.5		5.5		140		22			115		
60	Belleville loamy sand	6.96	2.7%		IIIw	4.5		3.2		115		18			90		



9C	Plainfield sand, lake plain, 6 to 12 percent slopes	6.12	2.3%		Vls												
26	Gilford sandy loam, 0 to 1 percent slopes	2.36	0.9%		llw				150				5				
W	Water	1.79	0.7%														
17A	Brems sand, 0 to 2 percent slopes	0.72	0.3%		IVs		2.3		70		16				45		
27	Adrian muck, 0 to 1 percent slopes	0.18	0.1%		Vw												
28	Houghton muck, 0 to 1 percent slopes	0.17	0.1%		Vw												
Weighted Average						2.4	1.8	0.9	0.2	70.6	43.7	11	7.4	*-	51.6	0.1	

Area Symbol: MI159, Soil Area Version: 11

*c: Using Capabilities Class Dominant Condition Aggregation Method

Soils data provided by USDA and NRCS.