

# Van Auken I Soils Map

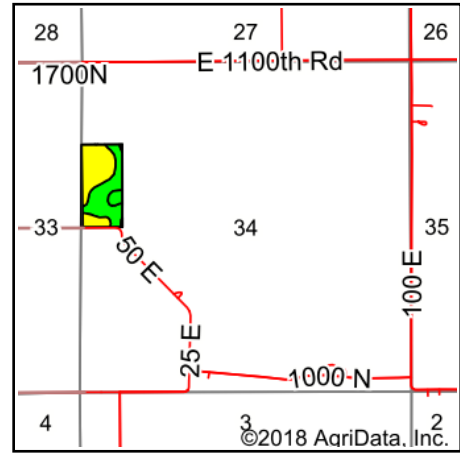

State: **Illinois**  
 County: **Edgar**  
 Location: **34-14N-14W**  
 Township: **Embarrass**  
 Acres: **20.35**  
 Date: **8/20/2018**

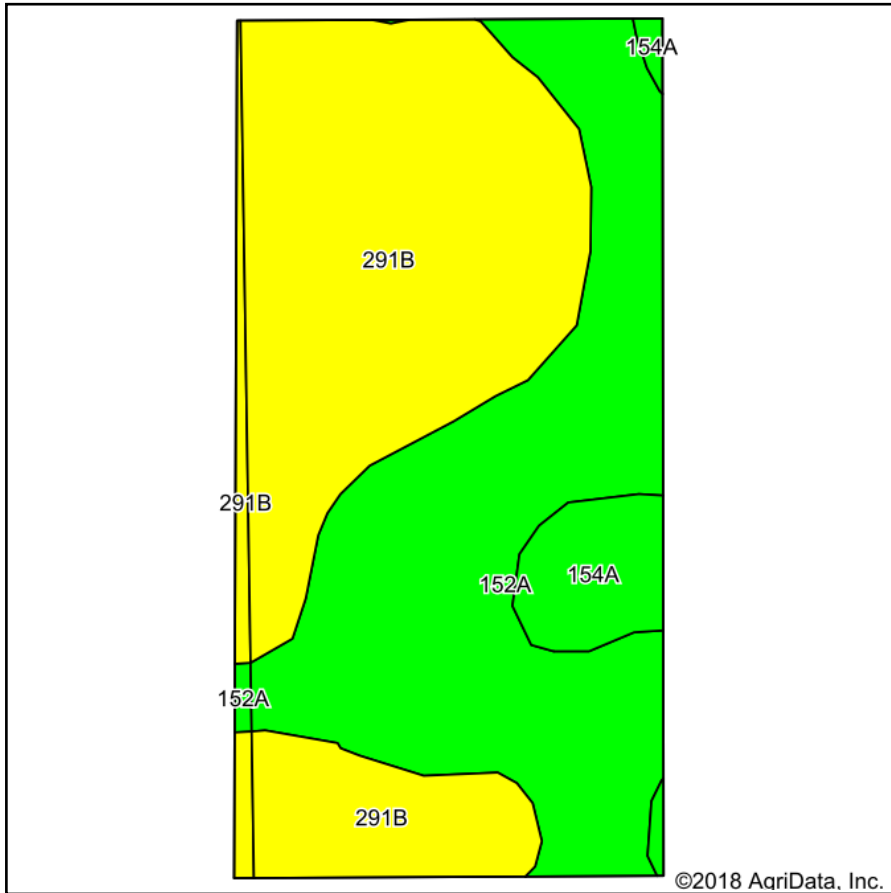

Area Symbol: IL029, Soil Area Version: 17  
 Area Symbol: IL045, Soil Area Version: 12

Code	Soil Description	Acres	Percent of field	Il. State Productivity Index Legend	Subsoil rooting <sup>a</sup>	Corn Bu/A	Soybeans Bu/A	Wheat Bu/A	Oats Bu/A <sup>b</sup>	Sorghum <sup>c</sup> Bu/A	Alfalfa <sup>d</sup> hay, T/A	Grass-le gume <sup>e</sup> hay, T/A	Crop productivity index for optimum management
**291B	Xenia silt loam, Bloomington Ridged Plain, 2 to 5 percent slopes	9.92	48.7%	291B	FAV	**160	**50	**63	**82	0	**4.47	0.00	**117
152A	Drummer silty clay loam, 0 to 2 percent slopes	8.64	42.5%	152A	FAV	195	63	73	100	0	0.00	5.64	144
154A	Flanagan silt loam, 0 to 2 percent slopes	1.24	6.1%	154A	FAV	194	63	77	102	0	0.00	5.90	144
**291B	Xenia silt loam, Bloomington Ridged Plain, 2 to 5 percent slopes	0.49	2.4%	291B	FAV	**160	**50	**63	**82	0	**4.47	0.00	**117
152A	Drummer silty clay loam, 0 to 2 percent slopes	0.06	0.3%	152A	FAV	195	63	73	100	0	0.00	5.64	144
<b>Weighted Average</b>						<b>177</b>	<b>56.3</b>	<b>68.1</b>	<b>90.9</b>	<b>*</b>	<b>2.29</b>	<b>2.77</b>	<b>130.2</b>

**Table: Optimum Crop Productivity Ratings for Illinois Soil by K.R. Olson and J.M. Lang, Office of Research, ACES, University of Illinois at Champaign-Urbana.** Version: 1/2/2012 Amended Table S2 B811

Crop yields and productivity indices for optimum management (B811) are maintained at the following NRES web site: <http://soilproductivity.nres.illinois.edu/>

\*\* Indexes adjusted for slope and erosion according to Bulletin 811 Table S3

<sup>a</sup> UNF = unfavorable; FAV = favorable

<sup>b</sup> Soils in the southern region were not rated for oats and are shown with a zero "0".

<sup>c</sup> Soils in the northern region or in both regions were not rated for grain sorghum and are shown with a zero "0".

<sup>d</sup> Soils in the poorly drained group were not rated for alfalfa and are shown with a zero "0".

<sup>e</sup> Soils in the well drained group were not rated for grass-legume and are shown with a zero "0".

Soils data provided by USDA and NRCS. Soils data provided by University of Illinois at Champaign-Urbana.

\*c: Using Capabilities Class Dominant Condition Aggregation Method