

Van Buren Soils Map

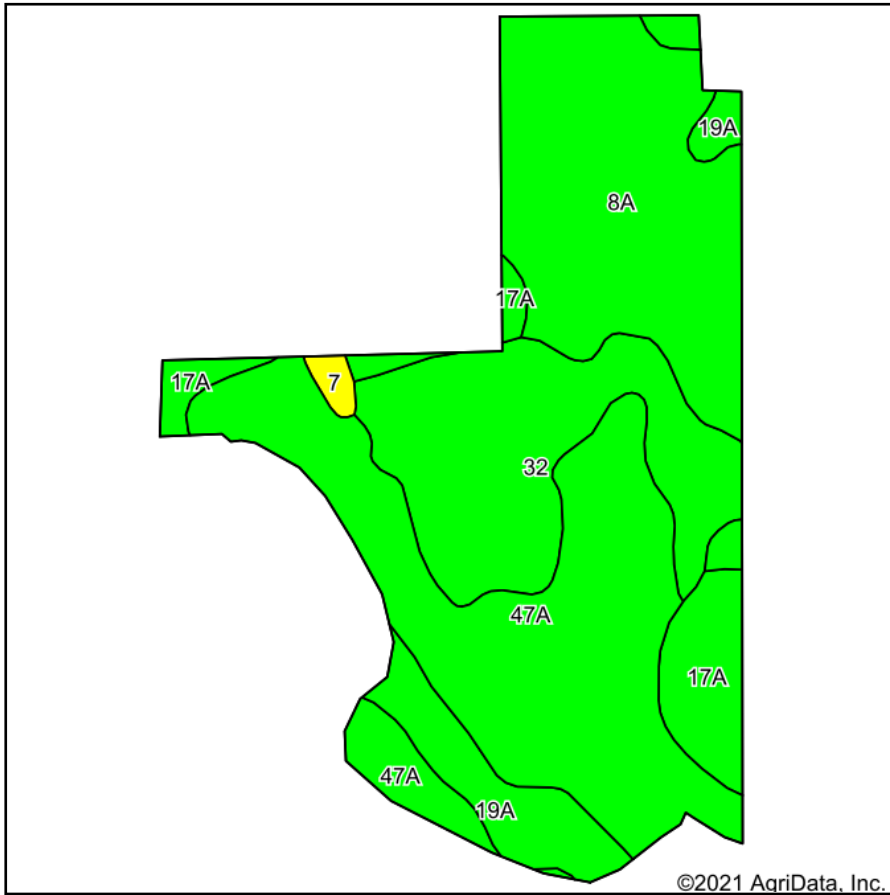

Soils data provided by USDA and NRCS.

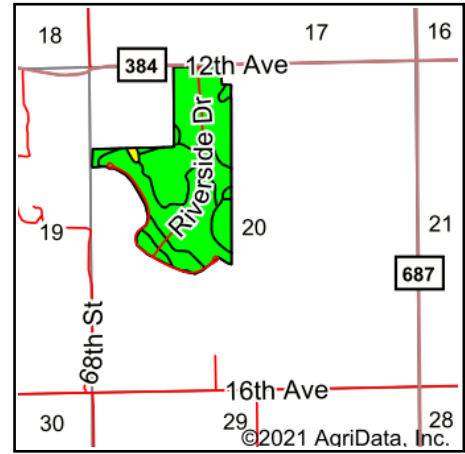

State: **Michigan**
 County: **Van Buren**
 Location: **20-1S-16W**
 Township: **Geneva**
 Acres: **96.23**
 Date: **7/21/2021**



Maps Provided By:



© AgriData, Inc. 2021

www.AgriDataInc.com



Area Symbol: MI159, Soil Area Version: 16

Code	Soil Description	Acres	Percent of field	NCCPI Corn Legend	Non-Irr Class *c	Corn	Soybeans	*n NCCPI Overall	*n NCCPI Corn	*n NCCPI Small Grains	*n NCCPI Soybeans
47A	Selfridge loamy sand, 0 to 3 percent slopes	34.36	35.7%		IIIw	110	35	55	55	44	41
8A	Morocco loamy sand, lake plain, 0 to 2 percent slopes	26.07	27.1%		IIIw	102	28	47	47	41	30
32	Colwood silt loam	20.36	21.2%		IIw	140	45	83	72	43	83
19A	Ottokee loamy fine sand, 0 to 3 percent slopes	7.50	7.8%		IIIs	98	36	58	58	45	39
17A	Brems sand, 0 to 2 percent slopes	7.23	7.5%		IVs	70	24	41	40	41	31
7	Glendora sandy loam	0.71	0.7%		VIw			7	6	4	5
Weighted Average						109.4	34.2	*n 57.6	*n 55.2	*n 42.5	*n 45.7

*n: The aggregation method is "Weighted Average using all components"

*c: Using Capabilities Class Dominant Condition Aggregation Method

Soils data provided by USDA and NRCS.